

AUTO-BREEZE







Cotton Candy Machine Instruction Manual Model #3052 & 3052SR



 **GOLD MEDAL**[®]
FUNFOOD EQUIPMENT & SUPPLIES

Cincinnati, OH 45241-4807 USA

Safety Precautions

	<p style="text-align: center;">⚠ DANGER</p> <p>Machine MUST be properly grounded to prevent electrical shock to personnel. Do NOT immerse the equipment in water. Do NOT use excessive water for cleaning. Unplug your machine before cleaning or servicing.</p>
	<p style="text-align: center;">⚠ DANGER</p> <p>Improper installation, adjustment, alteration, service or maintenance can cause property damage, injury, or death. Read the Installation, Operating, and Maintenance Instructions thoroughly before installing or servicing this equipment.</p>
	<p style="text-align: center;">⚠ WARNING</p> <p>Floss head rotates at 3450 RPM. Operator MUST keep hands and face clear of the floss head to avoid possible injury. Keep all spectators at a reasonable distance, and use a Floss Bubble for added customer protection.</p>
	<p style="text-align: center;">⚠ WARNING</p> <p>Keep all foreign objects out of floss head. To avoid possible eye injury, do not fill floss head with sugar while the head is on and rotating.</p>
	<p style="text-align: center;">⚠ CAUTION</p> <p>Do NOT allow direct contact with this equipment and the general public when used in food service locations. Only personnel that are trained and familiar with the equipment should operate the equipment. Carefully read all installation instructions before operation.</p>
	<p style="text-align: center;">⚠ CAUTION</p> <p>This machine is NOT to be operated by minors. Minors are classified as anyone under the age of 18.</p>

NOTE

Improvements are always being made to Gold Medal Products equipment. This information may not be the latest available for your purposes. It is critical that you call Gold Medal Products technical service department at 1-800-543-0862 for any questions about machine operations, replacement parts, or any service questions.

Installation Instructions

Inspection of Shipment:

After unpacking, check thoroughly for any damage which may have occurred in transit. Claims should be filed immediately with the transportation company. The warranty also does not cover damage that occurs in transit or damage caused by abuse or consequential damage due to the operation of this machine, since it is beyond our control.

Your Floss Machine warranty is described on the back page of this manual. This does NOT cover the motor bearings, since they can be damaged by the operator.

Electrical Requirements:

The following power supply must be provided:

15 amp, 60 Hz, 120VAC

	⚠ DANGER
	Machine must be properly grounded to prevent shock in case of electrical problems. Wall receptacle must be wired as shown on the receptacle. Failure to wire properly will void the warranty and can result in damage to motors, elements, relay, lights, etc.

Before You Plug In Machine:

1. Make sure the wall outlet can accept the grounded plugs (where applicable) on the power supply cord.
2. The wall outlet must have the proper polarity. If in doubt, have a competent electrician inspect the outlet and correct if necessary.
3. **DO NOT** use a grounded to un-grounded receptacle adapter.

(Continued on Next Page)

4. Remove all padding and restraints.
5. Loosen the two shipping bracket knobs, if applicable, (**as shown in figure 1 below.**) This will allow the motor mount casting to “float” freely on the springs.

Figure 1

Shipping Bracket Knobs: Turn counter-clockwise to loosen.

Controls and Their Functions

- Power Switch** – Supplies power to the machine without turning on any components. Also acts as a “Master” on/off switch. Turning the power switch off will turn motor and heat off. (Power Switch is located on the side of the machine)
- Candy Switch** – Turns motor and heat cycle on. Turning this switch “off” when finished making cotton candy allows the machine to start it’s cooling cycle. **Note:** Motor will continue turning during the cooling cycle, and will stop turning after 45-60 seconds. (Candy Switch is located on the front of the machine)

Operating Instruction

1. With the **CANDY SWITCH** “off”, turn the **POWER SWITCH** “on”. The spinner head will not start to rotate.
2. With the spinner head stopped, pour sugar into the spinner head. Fill to about the 90% level, DO NOT over-fill.
3. Turn the **CANDY SWITCH** to “on”. The spinner head will rotate and heat, after about 45 seconds the machine will start to make cotton candy.
4. When the spinner head is empty, or to stop making cotton candy, turn the **CANDY SWITCH** “off”. The cooling cycle will start. When the cooling cycle completes, the spinner head will stop rotating. When the spinner head is stopped; re-fill with sugar, turn the **CANDY SWITCH** “on”, and continue to make cotton candy.

Sugar for Your Cotton Candy

Our ready to use FLOSSUGAR is the preferred sugar for your new cotton candy machine. Our FLOSSUGAR gives you good rich colors, and great flavors, too. It is packed in handy half-gallon sealed cartons, with E-Z pour spout for filling your machine. FLOSSUGAR comes in 12 flavors, and you can easily change colors for greatest variety, and best sales.

Today 99% of the sugar manufactured is "Extra Fine Granulated" which does have some small particles that can slip through the slots in the spinner head without being melted. You can use plain white cane or beet sugar. If this becomes objectionable, you can seek out Medium Coarse, or sanding sugars. The larger crystal size will require a little more heat to melt. Read the label on the bag of sugar—today we see some "Free Flowing" sugar for restaurants, and it contains cornstarch, which will burn onto your spinner head, clogging it rapidly. We have also seen some cheap off-brand "sugar" which is a blend of sugar and dextrose or corn syrup. This product makes very poor cotton candy. Please make sure you get good sugar for your cotton candy machine.

Installation of Floss Stabilizer

1.

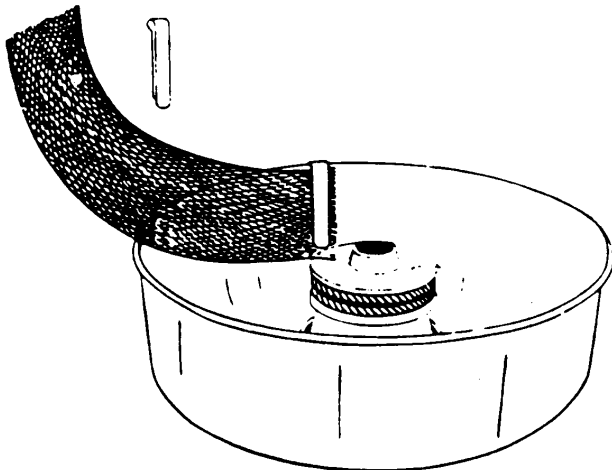

2.

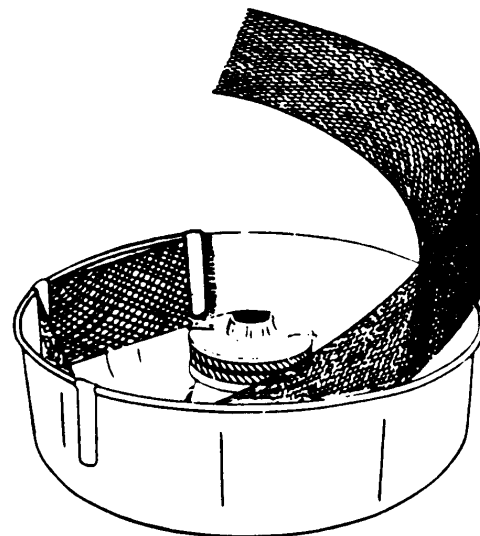

3.

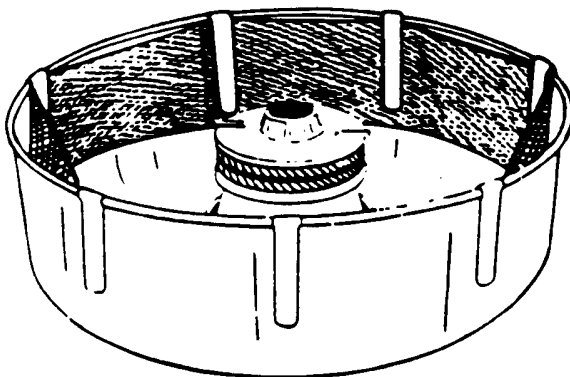

4.

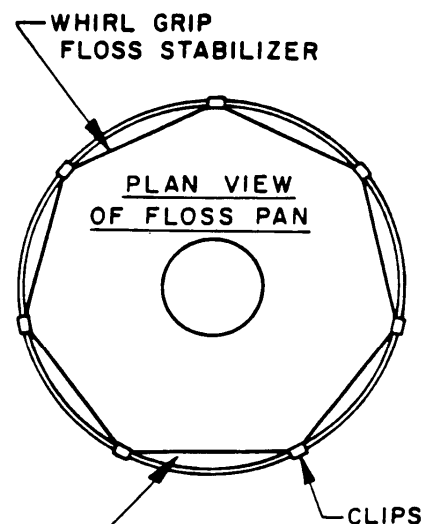

AIR SPACE IS REQUIRED
BETWEEN PAN AND
STABILIZER FOR PROPER
OPERATION.

Making Floss



Pick a cone; if it sticks in the stack of cones, twist it off the stack.

Hold an inch or two of the pointed end of the cone between two fingers and a thumb. With a light flicking action, roll cone in the web of floss building up in the pan. Lift the cone up with the ring of floss attached and rotate the cone to wrap the floss. **DO NOT** roll floss while the cone is inside the pan. This will pack the floss too tightly.

If the floss fails to stick to the cone, pass the cone near the spinner head to pick up a "starter" of melted sugar. Lift the cone out of the pan and wrap the floss with a "figure eight" movement of the hand. This leaves giant pockets and makes the final product appear larger. Make sure room humidity is not too high, or product will be "heavy".

1. Grip cone as shown.
2. Break into web of floss with the cone.
3. Wind the sugar onto the cone.
4. Lift web of floss from the pan and roll onto the cone.

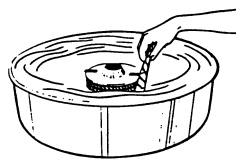
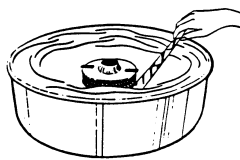
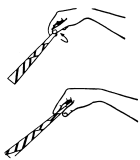

5.



6.

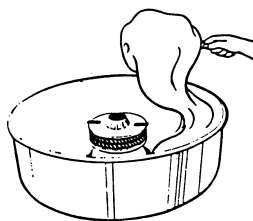

7.

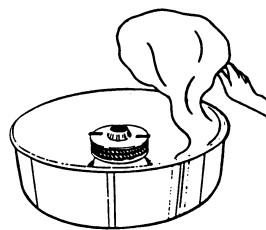

8.

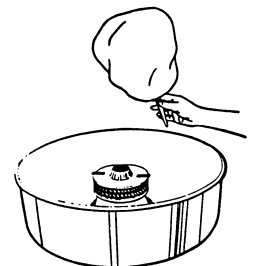

- Do NOT put hands or objects in rotating spinner head!
- Do NOT fill spinner head with sugar while it is rotating!
- Operator should ALWAYS wear eye protection!
- Use floss cone to collect cotton candy.

Floater Adjustment:

In operation, the floss will collect on the FLOSS STABILIZER (if used). If the floss collects "low" on the stabilizer, twist the front (leading) edge of the leather floaters down. You get more lift and the floss will collect higher.

Form leather floaters as shown. This creates a lifting action to float the floss higher on the outside wall of the floss pan.

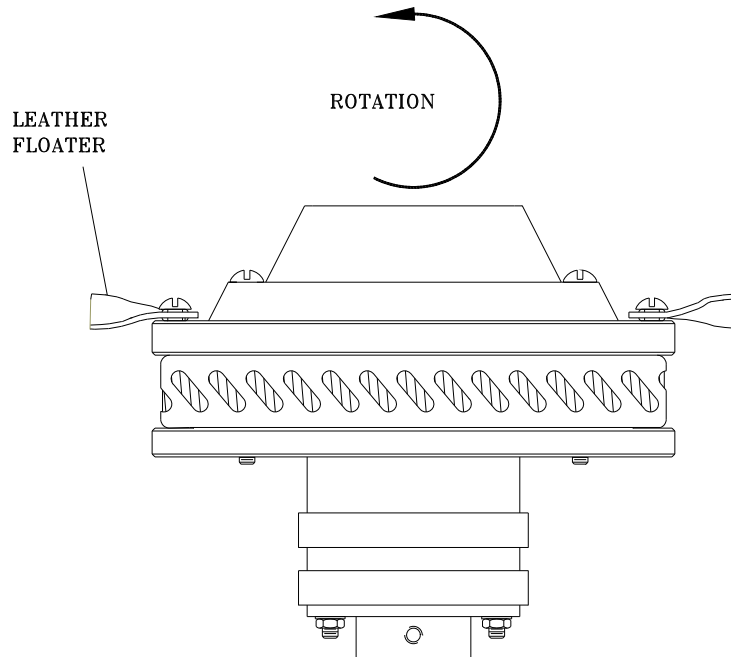

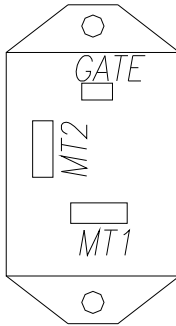

How to check a triac:



1. Set the multimeter for ohms or continuity.
2. Disconnect all machine leads from the triac.
3. Connect the positive ohmmeter lead to MT2 and the negative lead to MT1. The ohmmeter should indicate no continuity (OL) through the triac.
4. Using a separate jumper lead, connect the gate of the triac to MT2. The ohmmeter should indicate continuity. (less than 100 ohms)
5. Reconnect the triac so MT1 is connected to the positive ohmmeter lead and the negative lead to MT2. The ohmmeter should indicate no continuity (OL) through the triac.
6. Using a separate jumper lead, connect the gate of the triac to MT2. The ohmmeter should indicate continuity. (less than 100 ohms)

MAINTENANCE INSTRUCTIONS

	<p style="text-align: center;">⚠ DANGER</p> <p>Do NOT immerse the equipment in water. Unplug your machine before servicing.</p>
	<p style="text-align: center;">⚠ WARNING</p> <p>Adequate eye protection must be used when servicing this equipment to prevent the possibility of injury.</p>
	<p style="text-align: center;">⚠ CAUTION</p> <p>THE FOLLOWING SECTIONS OF THIS MANUAL ARE INTENDED ONLY FOR QUALIFIED SERVICE PERSONNEL WHO ARE FAMILIAR WITH ELECTRICAL EQUIPMENT. THESE ARE NOT INTENDED FOR THE OPERATOR.</p>

Floss Bands and Elements

Disassembly and Removal

1. Remove all sugar from the head of the machine before disassembling. If the unit is inoperative, carefully turn the machine on its side and gently shake the sugar out. (Make sure shipping brackets are tightened before removing sugar.)
2. Remove the four spinner cap retainer screws and spinner cap. In some cases, the sugar has caused the cap and band to stick together. Applying gentle pressure with the heel of the hand should free the parts for removal.
3. Remove the element lead wire retaining screws with a ¼" nut driver and remove the element lead wires from the terminals in the floss head. This will allow the band and element to be removed.
4. Remove the band and element. If there is excessive sugar buildup, soak the band and element in hot water until the sugar dissolves. When the sugar has been removed, allow the band and element to dry over-night.
5. Re-assemble the floss head components, using the above steps for a reference.

Troubleshooting

Excessive Vibration

1. If the equipment is new, verify that shipping bolts have been loosened and packing materials were removed from the machine.
2. When adding sugar to the floss head, always fill it 90% full to obtain a balanced condition in the head, and eliminate excessive vibration. DO NOT add sugar with motor running!
3. Check for stretched, or uneven suspension springs.
4. Run the sugar completely out, then check for foreign objects or sugar lumps in the head assembly.

ORDERING SPARE PARTS

*** Always speak to a Gold Medal Products Technical Service Advisor before ordering any parts to help ensure accuracy for your product. Included diagrams may not be the latest information.**

1. Identify the needed part by checking it against the photos, illustrations, and/or parts list.
2. When ordering, please include part number, part name, and quantity needed.
3. Please include your model name, serial number, and date of manufacture (located on the machine nameplate) with your order.
4. Address all parts orders to:

Parts Department
Gold Medal Products Co.
10700 Medallion Drive
Cincinnati, Ohio 45241-4807

Or, place orders by phone or online:

(800) 543-0862

(513) 769-7676

Fax: (513) 769-8500

E-mail: info@gmpopcorn.com

Web Page: www.gmpopcorn.com

Cabinet Assembly – Front View

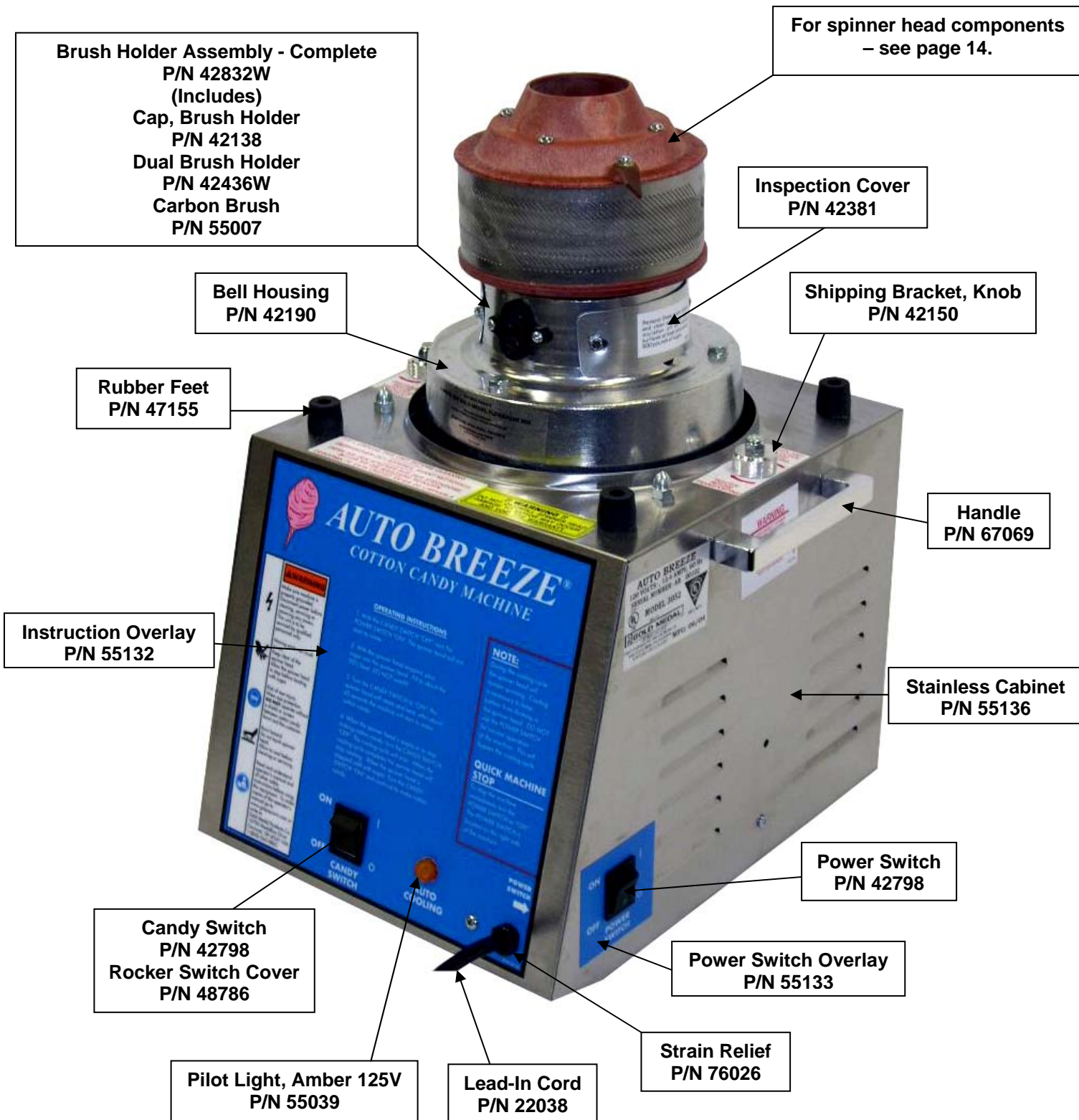

Cabinet – Bottom View

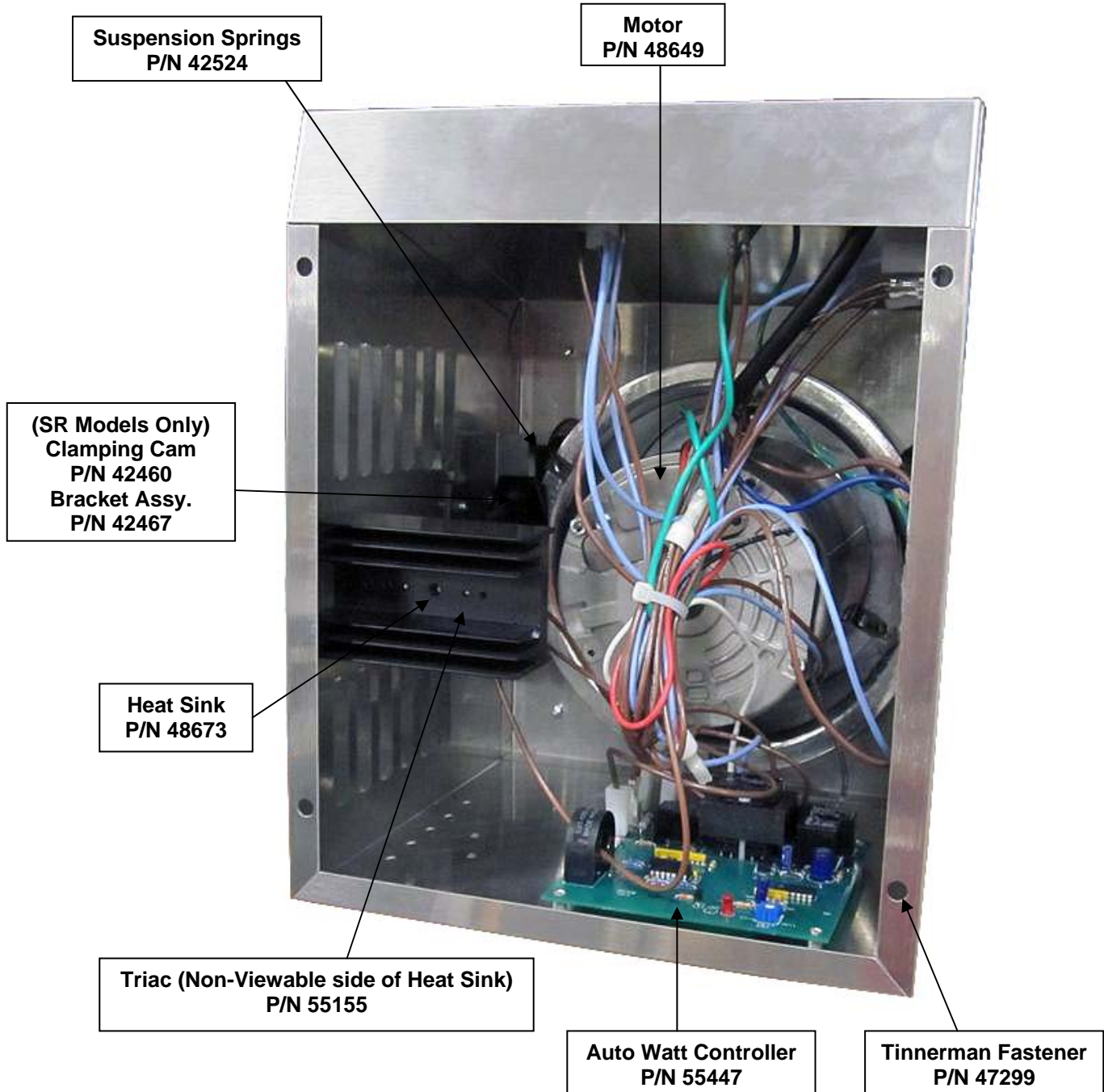

Cabinet – Front View 3052SR

Lock N Go Handle
P/N 42464

Cabinet Weld
P/N 42475



8-32 PH Screw – 1/2" (x8)
P/N 47124

Clamping Shaft (x2)
P/N 42462

Handle Bar
P/N 42464

5/16 – 18 x 1/2" Screw (x4)
P/N 46638

Clamping Bracket Assy. (x2)
P/N 42467

Handle Spacer (x2)
P/N 42468

Clamping Cam (x2)
P/N 42460

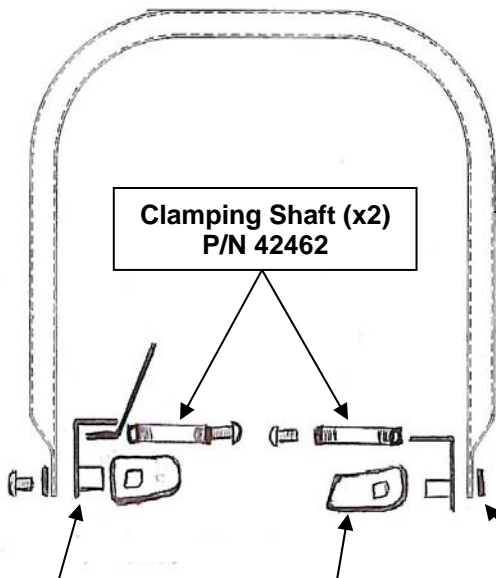

Spinner Head Assembly

Item No.	Part No.	Description	Qty./Machine
	55139	Spinner Head Complete	1
1	48767	8-32 Locknut, Reversible	2
2	43166	Spinner Cap, High Capacity	1
3	42281	Lower Spinner Head	1
4	42045	8-32 x 1/4" Hex Head Whiz Lock Screw	2
5	42162	Terminal Guard, Phenolic	1
6	20054	Bottom Washer, Phenolic	1
7	20010	Leather Floater	2
8	42126	Slip Ring 3/8" Wide	2
9	48041	Acorn Nut, Nylon	1
10	43603	Screw, #10-24 x 3 1/4"	4
11	42192	Screw, #8-32 x 5/8 PH PAN	2
12	42413	Set Screw, 1/4-20 x 2 1/2"	1
13	42127	Slip Ring Stud	2
14	42301	#10-32 Hex Nut, Brass	4
15	42215	#10 External Tooth Washer	4
16	74125	Set Screw, 1/4-20 x 3/8"	1
17	42305	Terminal Assembly	2
1,18,19,20, 21	48784	Floss Band Assembly W/ Element,Element Clamps, Counterweight & Nut	1
22	42437	Upper Spinner Head	1

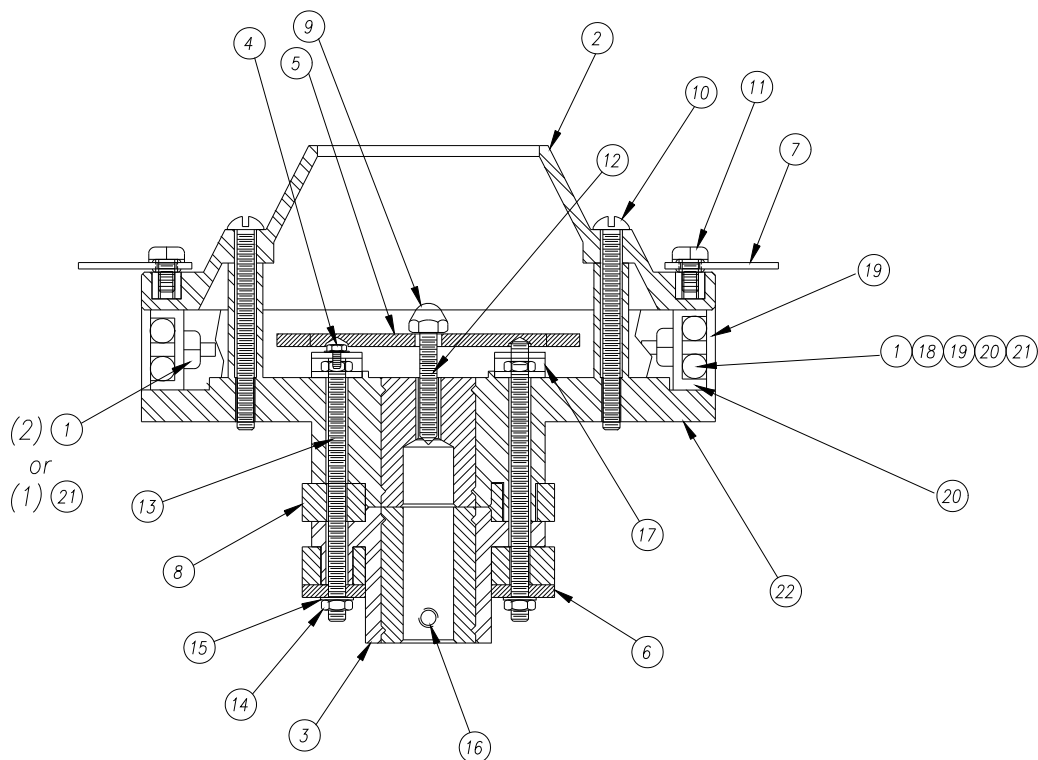

Electrical Schematic – 3052 & 3052SR

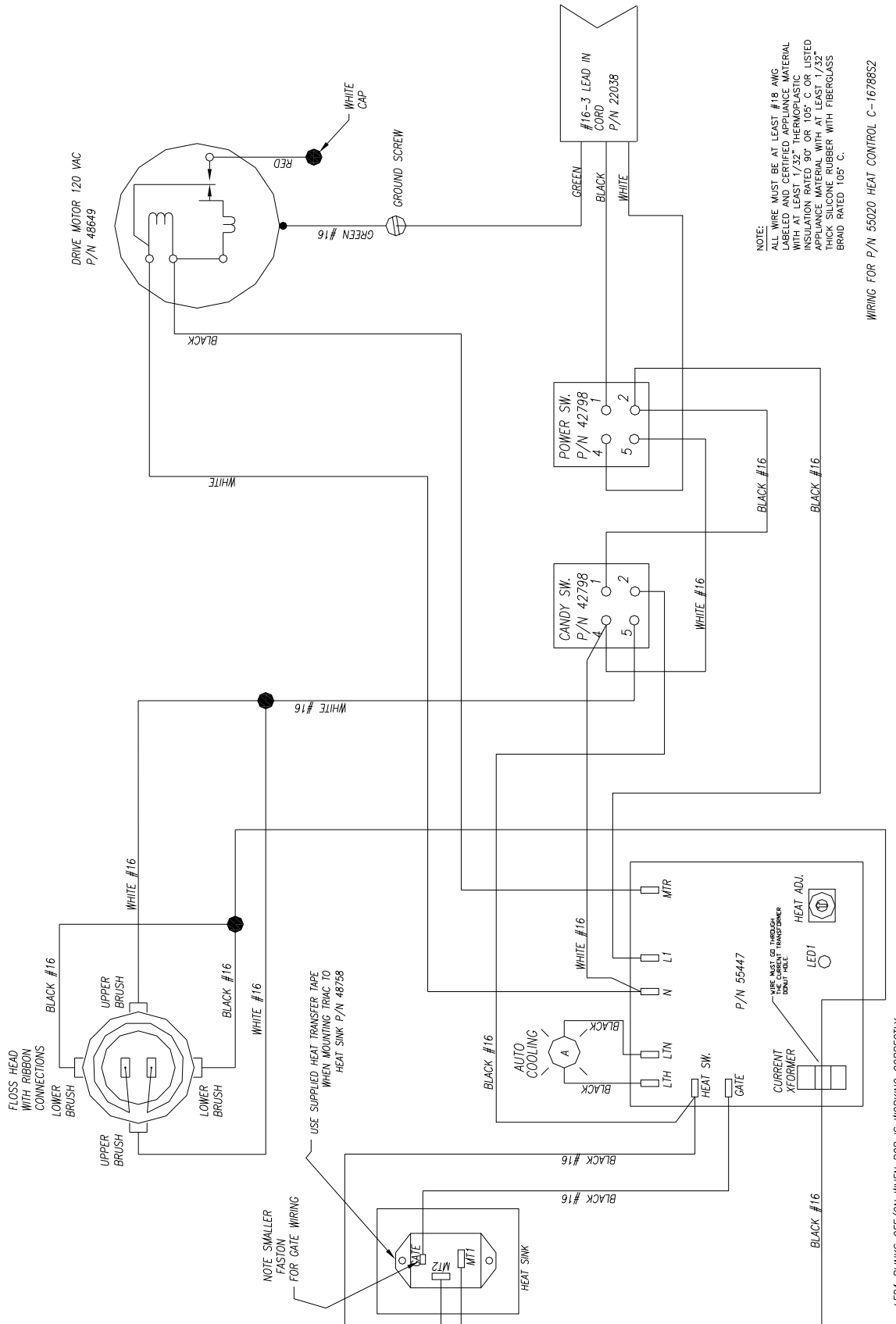

NOTE:
ALL WIRE MUST BE AT LEAST #18 AWG
LABELED AND CERTIFIED APPLIANCE MATERIAL
WITH AT LEAST 1/32" THERMOPLASTIC
INSULATION RATED 90° OR 105° C OR LISTED
APPLIANCE MATERIAL WITH AT LEAST 1/32"
THICK SILICONE RUBBER WITH FIBERGLASS
BRAID RATED 105° C.

WIRING FOR P/N 55020 HEAT CONTROL C-1678852

NOTE SMALLER
FASTON
FOR GATE WIRING

USE SUPPLIED HEAT TRANSFER TAPE
WHEN MOUNTING TRMC TO
HEAT SINK P/N 48758

WIRE MUST GO THROUGH
TRMC TO HEAT TRANSFER TAPE

LED1 BLINKS OFF/ON WHEN PCB IS WORKING CORRECTLY.
LED1 IS ON STEADY IF THE TRMC HAS FAILED OPEN OR SHORTED.
HEAT ADJ. WILL VARY THE WATTS TO THE FLOSS HEAD +/- 10%
CENTER POSITION IS NOMINAL, CGW IS LESS WATTS.
TURN OFF THE MAIN POWER TO THE MACHINE TO ADJUST.
IF THE AUTO COOLING LIGHT BLINKS OFF/ON WHILE THE MACHINE IS
RUNNING IT MEANS THE INPUT VOLTAGE TO THE MACHINE IS LESS THAN
105 VOLTS. WITH THIS LOW VOLTAGE THE MACHINE MAY NOT WORK OR THE
FLOSS OUTPUT WILL BE SLOWER THAN VOLTAGES ABOVE 105 VOLTS.

WARRANTY

WE WARRANT to the original purchaser the Gold Medal equipment sold by us to be free from defects in material or workmanship under normal use and service. Our obligation under this warranty shall be limited to the repair or replacement of any defective part for a period of six (6) months from the date of sale to the Original Purchaser with regard to labor and two (2) years with regard to parts and does not cover damage to the equipment caused by accident, alteration, improper use, voltage, abuse, or failure to follow instructions.

THIS WARRANTY IS IN LIEU OF ALL OTHER WARRANTIES EXPRESSED OR IMPLIED, AND OF ALL OTHER OBLIGATIONS OR LIABILITIES ON OUR PART, INCLUDING THE IMPLIED WARRANTY OF MERCHANTABILITY. THERE ARE NO WARRANTIES WHICH EXTEND BEYOND THE DESCRIPTION ON THE FACE HEREOF. We neither assume, nor authorize any other person to assume for us, any other obligation or liability in connection with the sale of said GOLD MEDAL equipment or any part thereof.

The term "Original Purchaser" as used in this warranty shall be deemed to mean that person, firm, association, or corporation who was billed by the GOLD MEDAL PRODUCTS COMPANY, or their authorized distributor for the equipment.

THIS WARRANTY HAS NO EFFECT AND IS VOID UNLESS THE ORIGINAL PURCHASER FIRST CALLS GOLD MEDAL PRODUCTS COMPANY AT 1-800-543-0862 TO DISCUSS WITH OUR SERVICE REPRESENTATIVE THE EQUIPMENT PROBLEM, AND, IF NECESSARY, FOR INSTRUCTIONS CONCERNING THE REPAIR OR REPLACEMENT OF PARTS.



GOLD MEDAL PRODUCTS COMPANY

10700 Medallion Drive

Cincinnati, Ohio 45241-4807 USA

www.gmpopcorn.com

Phone: 1-800-543-0862

Fax: 1-800-542-1496

© The text, descriptions, graphics and other material in this publication are the proprietary and exclusive property of Gold Medal Products Company and shall not be used, copied, reproduced, reprinted or published in any fashion, including website display, without its express written consent.